



CALIBER

COMPANY



FLEX BUILDING FOR SALE

1525 E Army Post Rd, Des Moines, IA 50320

MATT SHAW
515.360.2247
matt.shaw@calibercompany.com
Licensed in IA



CALIBER
COMPANY

1525 E Army Post Rd, Des Moines

FOR LEASE

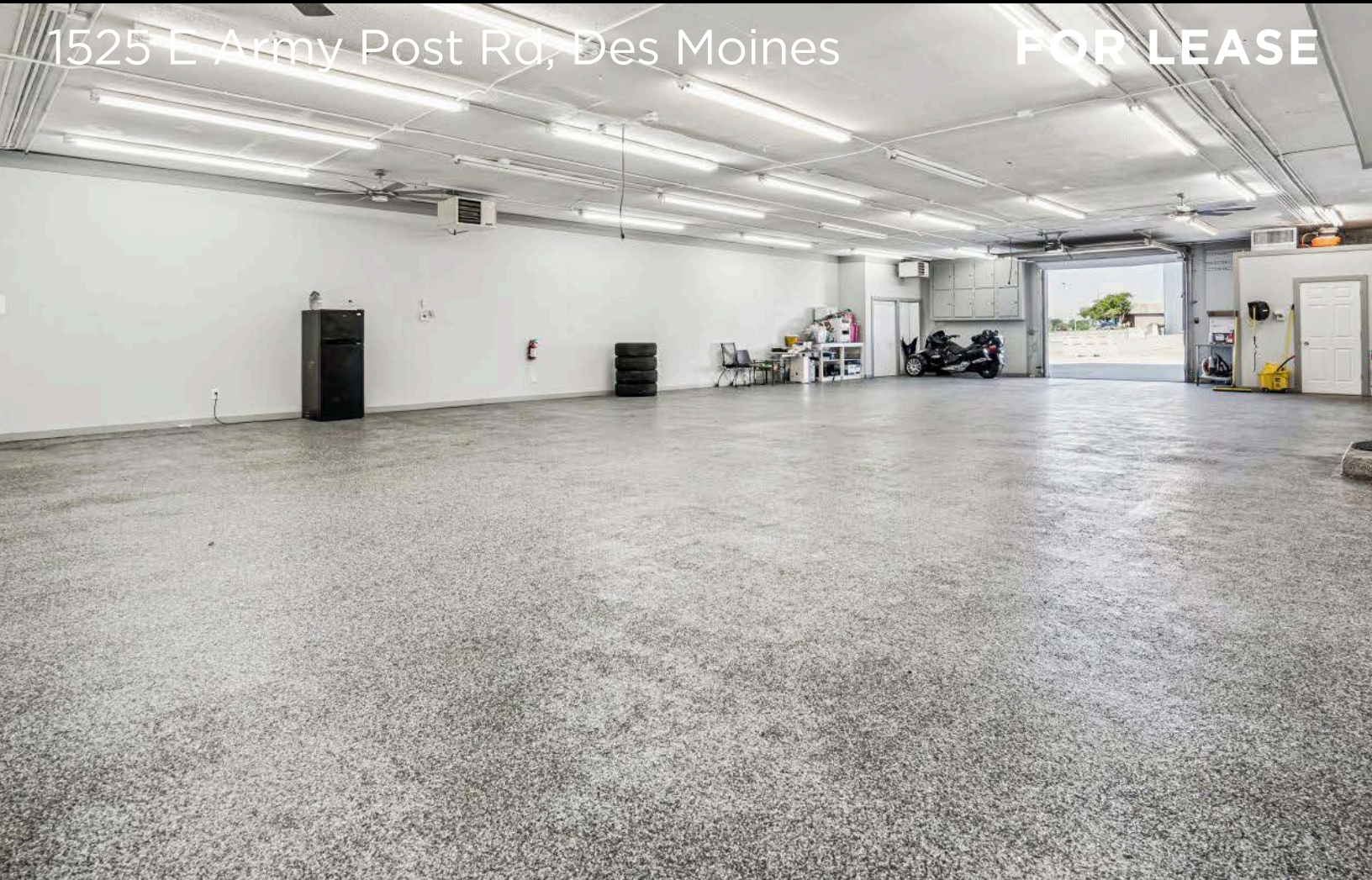

PROPERTY DESCRIPTION

For Sale: Clean, Updated Flex Building with Recent Upgrades

This 3,600 SF flex building offers a rare turnkey opportunity for owner-users or investors. The property features a newly completed warehouse/shop area with durable epoxy-coated flooring, a 10' overhead door, with approximately 2,300 SF of shop / warehouse space and 1300 sqft of office and breakroom. The entire building is heated and cooled with a floor drain in the shop area and 25 parking spots

Recent improvements include a newer roof, updated AC unit, refreshed exterior paint, new gutters, a resurfaced parking lot, and modern epoxy floor covering. Security and surveillance system installed and included. Located just off SE 14th Street and Army Post Road—only one mile north of the Hwy 5/65 interchange.



CALIBER COMPANY

OFFERING SUMMARY

Building Size:	3,600 SF
Sale Price	\$499,000
Building Type	Flex
Zoning:	EX
Overhead Door:	10'





CALIBER COMPANY

RETAIL MAP



FLOOR PLAN

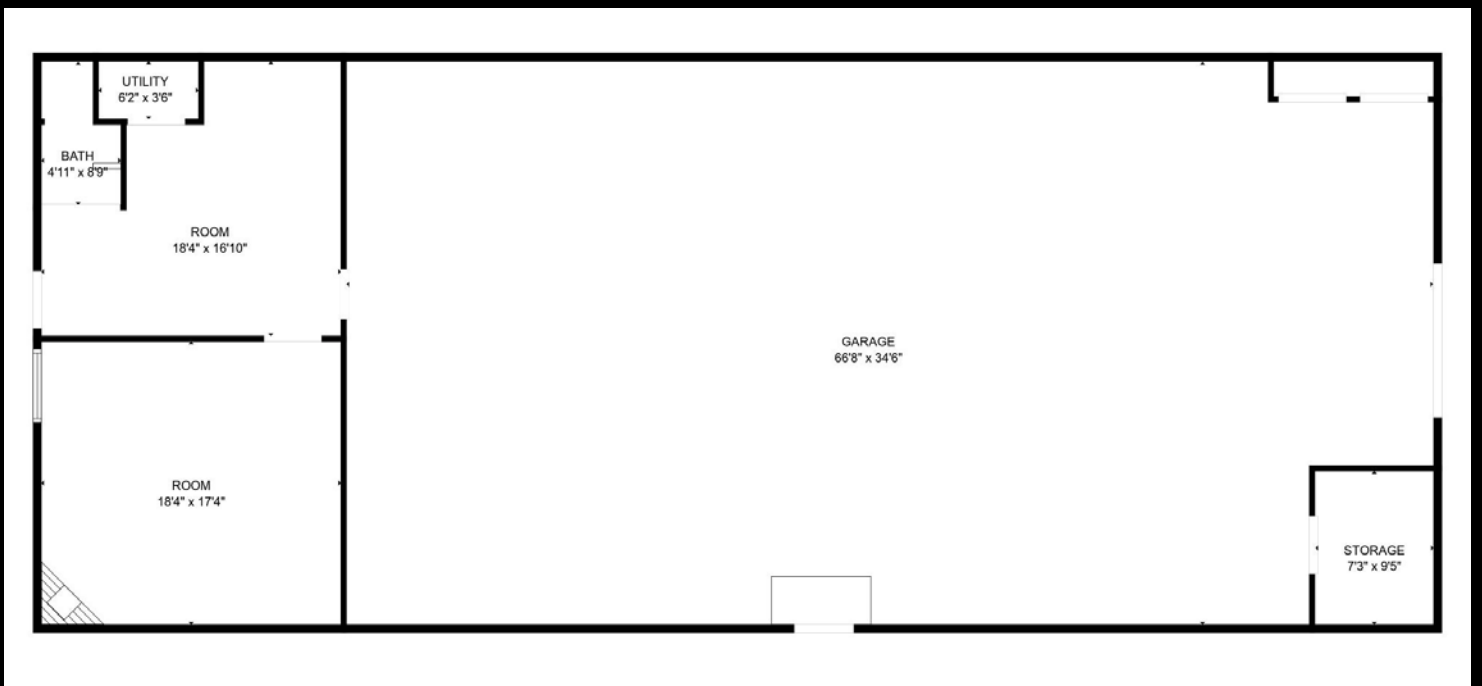



CALIBER COMPANY

INTERIOR PHOTOS





CALIBER
COMPANY

LISTING AGENTS



COMMERCIAL AGENT

MATT SHAW

matt.shaw@calibercompany.com

(515) 360-2247

